

Double Wall Insulated Rectangular Duct

DESIGN NOTES

- ⇒ Double Wall Rectangular Duct & Fittings are fabricated from galvanized steel meeting ASTM-A653-96 standards.
- ⇒ Materials Options:
 - ⇒ 304 Stainless Steel ASTM-A-240
 - ⇒ 316 Stainless Steel ASTM-A-240
 - ⇒ Aluminum 3003H14 ASTM-B-209
- ⇒ Double Wall Rectangular Duct is for positive pressure applications only unless special designs are used.
- ⇒ Inner skin can be solid or perforated galvanized steel.
- ⇒ Reference SMACNA tables 1" - 10" W.G. for outer pressure skin gauging profile.
- ⇒ All perforated inner skin will be 22 gauge with 3/32" diameter holes with a 23% open area.
- ⇒ Thermal conductivity is .27 @ 75° ambient temperature for 1" thick fiberglass insulation. Other insulation thicknesses available upon request.
- ⇒ Joint connection, unless otherwise specified, will be TDC flange.
- ⇒ Seam construction, unless otherwise specified, will be a Pittsburgh seam.
- ⇒ Reinforcement will be external black angle iron unless otherwise specified.

Omni Double Wall Rectangular Duct & Fittings are fabricated from galvanized steel in accordance with SMACNA Duct construction standards.

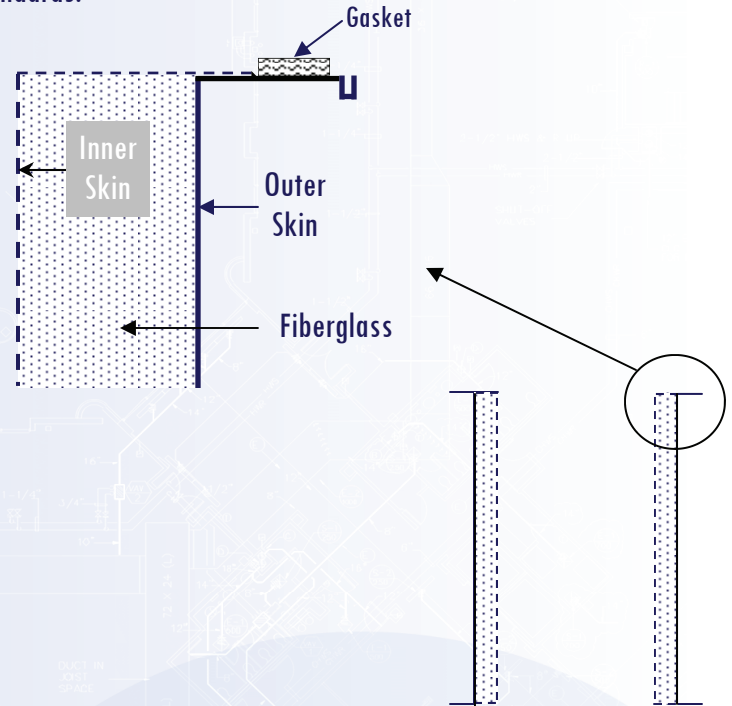

***Note: Check to indicate variations from standard construction methods**

Alternative Joint Connectors*

Ductmate

Alternative Seam Construction*

Welded

Inner skin Material

Perforated

Solid

Seam Sealant Available*

Yes

No

Job Name: _____

Location: _____

Mechanical Contractor: _____

Job No: _____

Manufacturer : **Omni Duct Systems, Toll Free (888) 444-DUCT (3828)**

Date: _____