

Dura Flange Round and Oval Connector

- ⇒ While SMACNA does not evaluate or endorse any proprietary products, we encourage the development of new HVAC products and technology, and set guidelines and standards for products to meet.
- ⇒ Dura Flange is constructed of 18 and 20 gauge material. All of our Flanges have a profile similar to that of the T-25 connector, as referenced in SMACNA 1995 edition, rendering it equivalent to SMACNA T-25 Reinforcement Rating.
- ⇒ Dura Flange has been tested from 6" Negative W.G. to 10" Positive W.G. with virtually no leakage

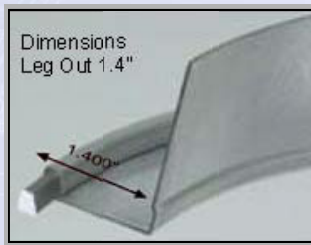

Sizes	Gauge	Type of Flange
10" - 14"	18Ga.	Round
16" - 52"	20Ga.	Round
53" - & above	18Ga.	Round
All	18Ga.	Oval

Dura Flange is Manufactured by HFC Enterprises.
 See www.hfcenterprises.com for more information.

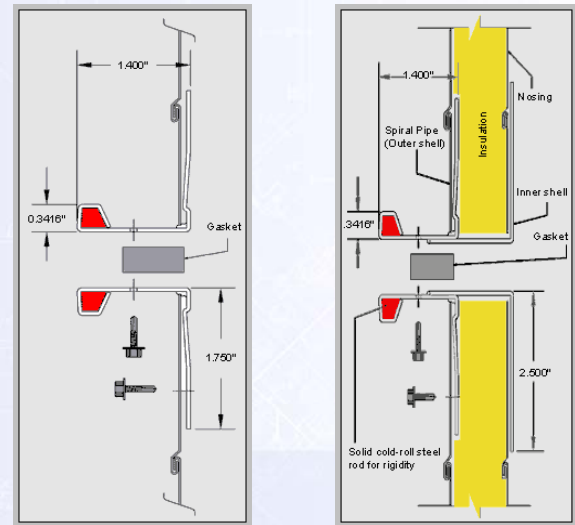

Single Wall

Double Wall

***Note: Check to indicate variations from standard construction methods**

Flange Type*

- Single Wall
- Double Wall

Flange Shape*

- Round
- Flat Oval

Insulation Thickness*

- 1" Thick _____
- 2" Thick _____

www.omniduct.com

Job Name: _____

Location: _____

Mechanical Contractor: _____

Job No: _____

Manufacturer : **Omni Duct Systems, Toll Free (888) 444-DUCT (3828)**

Date: _____